

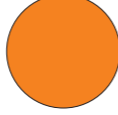

Legende

vorhandene Möbel
 4 x 160 x 84 cm
 2 x 84 x 84 cm
 1 x 150 cm rund
 30 Stühle
 2 Stühle Lehne
 4 Stühle Barock

-  Stuhl 40 x 30
-  Tisch rund 150 cm
-  Tisch 160 x 84
-  Tisch 84 x 84

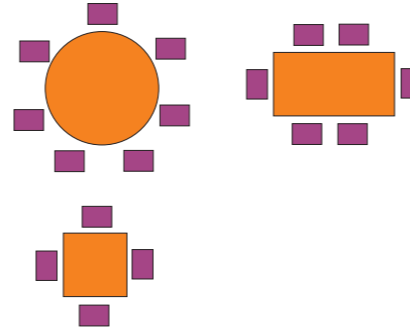

Musterplan

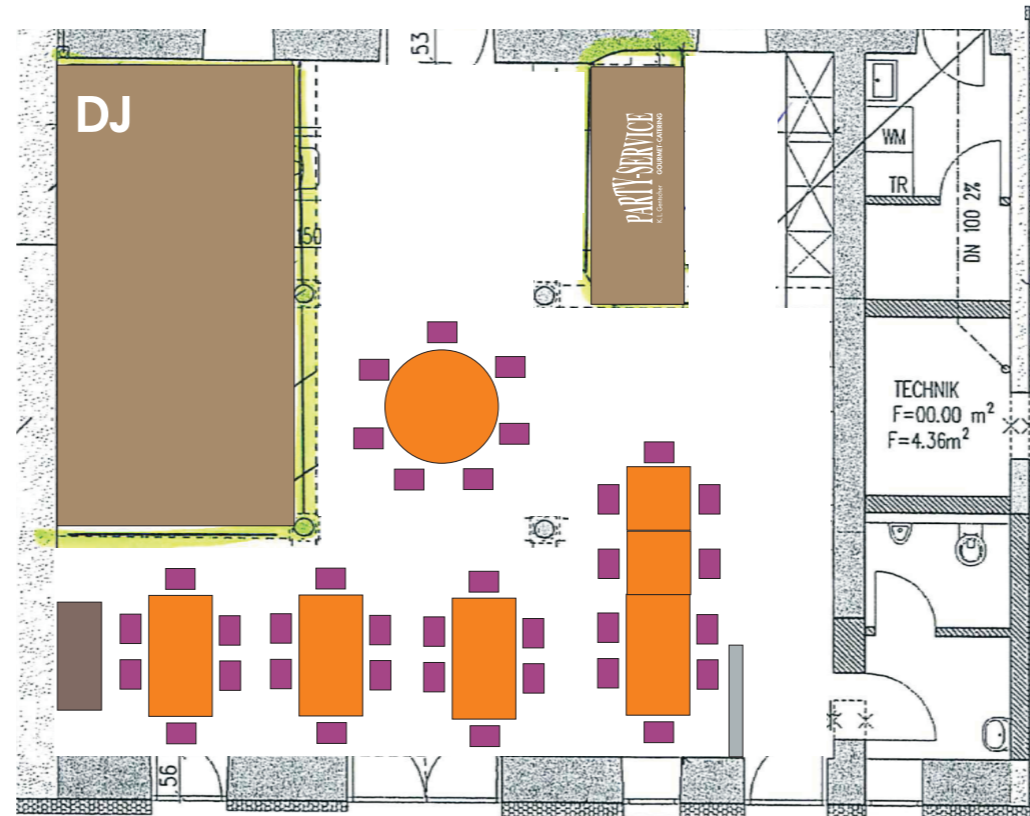

PARTY-SERVICE
 K.L. Gentscher GOURMET-CATERING